

## **Welcome to the East Area Planning Committee**

- **This planning committee meeting is held in public, but it is not a public meeting.**
- **There will be opportunity for the public to address the committee on each application.**
- **If you wish to speak for or against a planning application, you will need to have either requested it in advance, or fill out and hand in one of the available speaker forms.**
- **Information on meeting protocol and conduct at committee is set out in the Code of Practice.**
- **You can find a copy of the Code of Practice in the committee agenda, just before the first planning application report.**



[www.oxford.gov.uk](http://www.oxford.gov.uk)



# Site plan



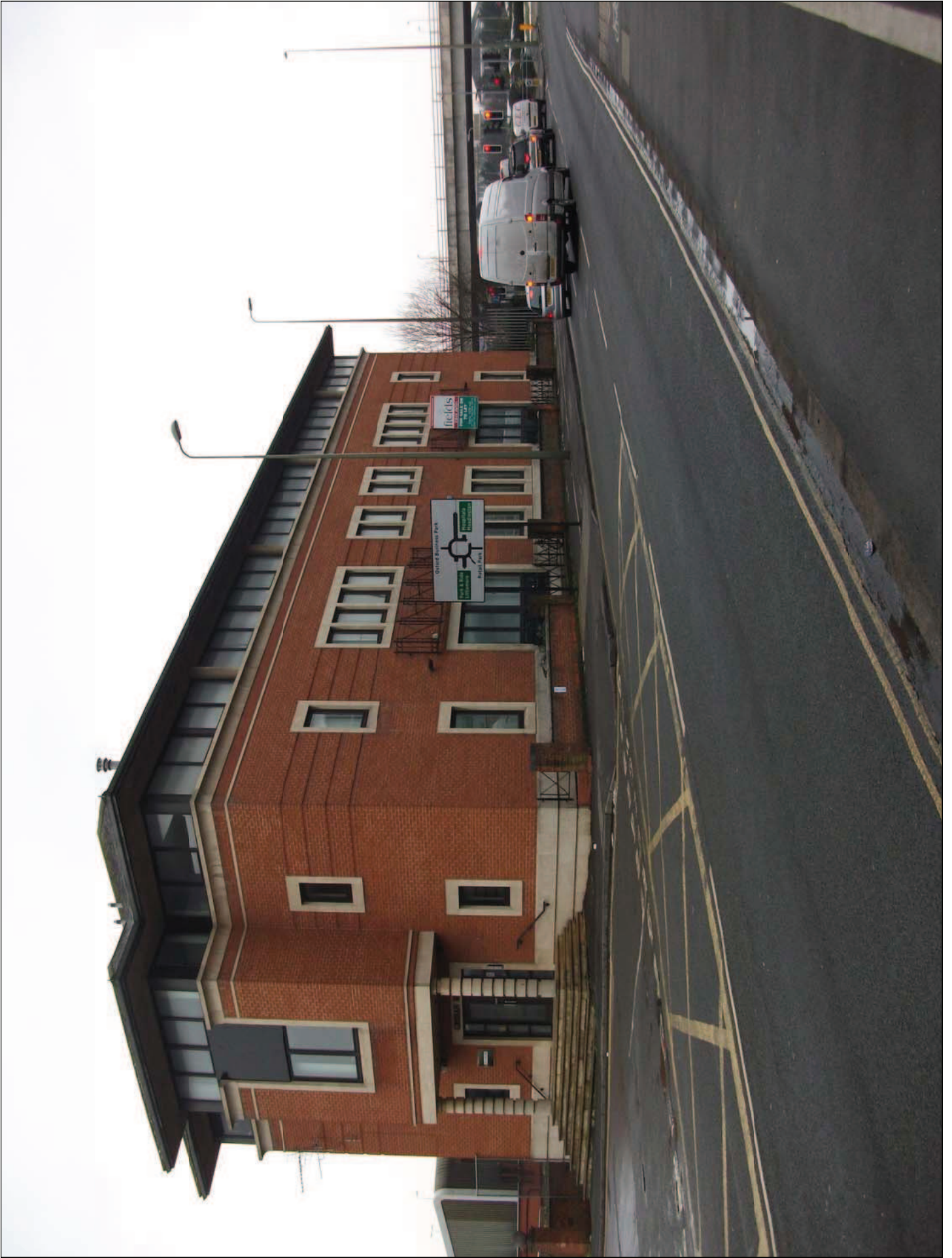

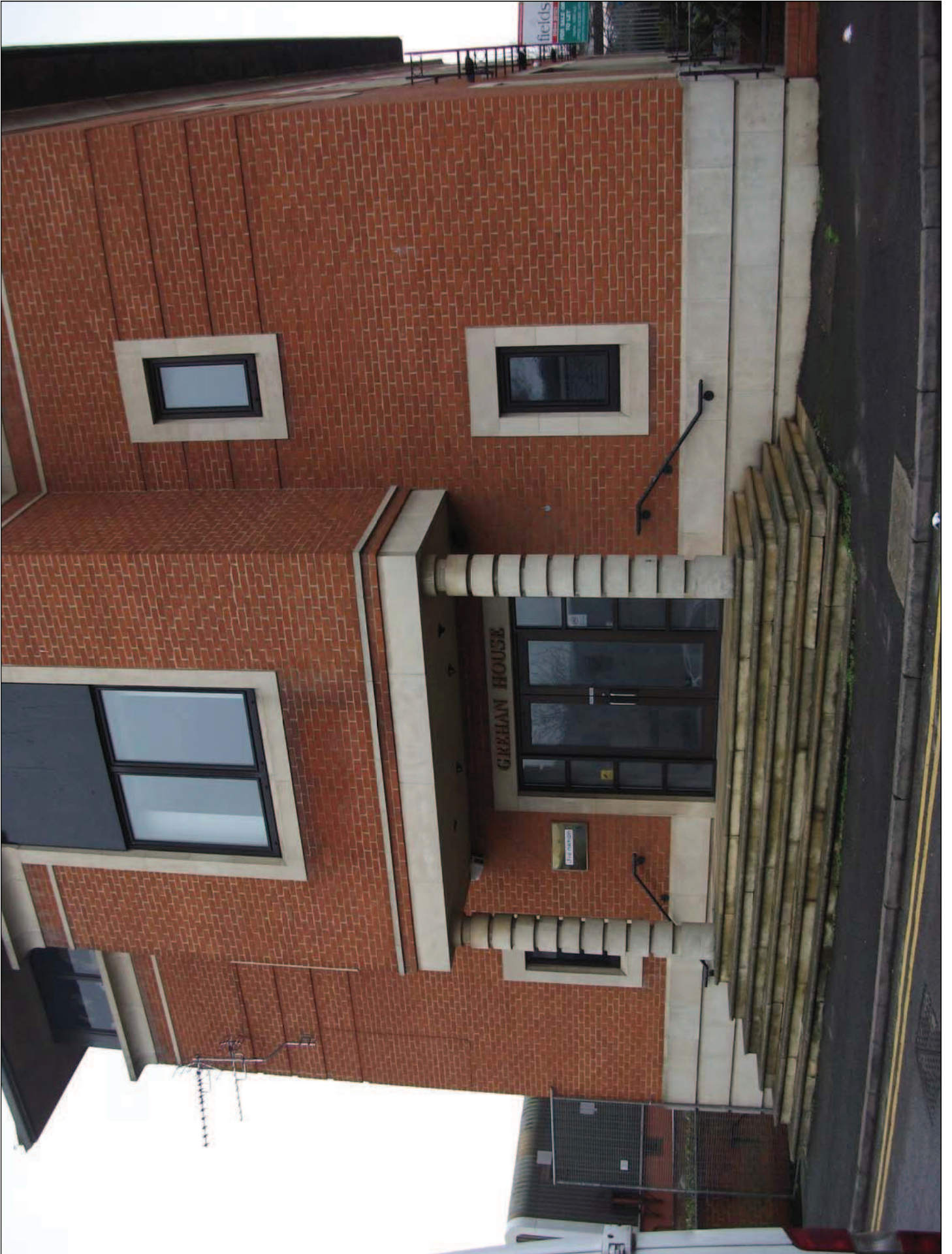



# Ground floor plan

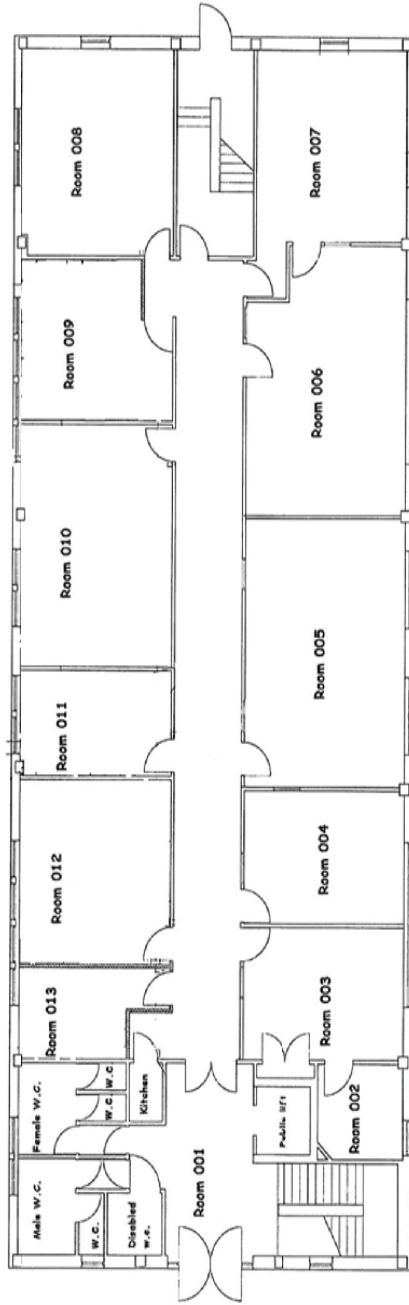

GROUND FLOOR PLAN-REDEEMER'S RELIEF AGENCY INTERNATIONAL (RAIN)  
(SCALE 1:50 AT A1)

**LEGEND**

- Room 001 - Public Entrance Lobby
- Room 002 - Server
- Room 003 - Administration (2no. Staff - Administrators)
- Room 004 - Meeting room
- Room 005 - Fundraising, Supporter relations and E-commerce operations (2no. staff)
- Room 006 - Programme learning & development and Policy, campaign & advocacy (2no. staff)
- Room 007 - Health, Education, Water, Sanitation and Food Security (3no. Staff)
- Room 008 - Programme Funding, Legal & Legacy and Supporter marketing (3no. staff)
- Room 009 - Programme Support and Logistics (2no. staff)
- Room 010 - Meeting Room
- Room 011 - Human Resources and Finance (2no. Staff)
- Room 012 - CEO Office (1no. Staff)
- Room 013 - Receptionist and PA to CEO (2no. staff)

# First floor plan

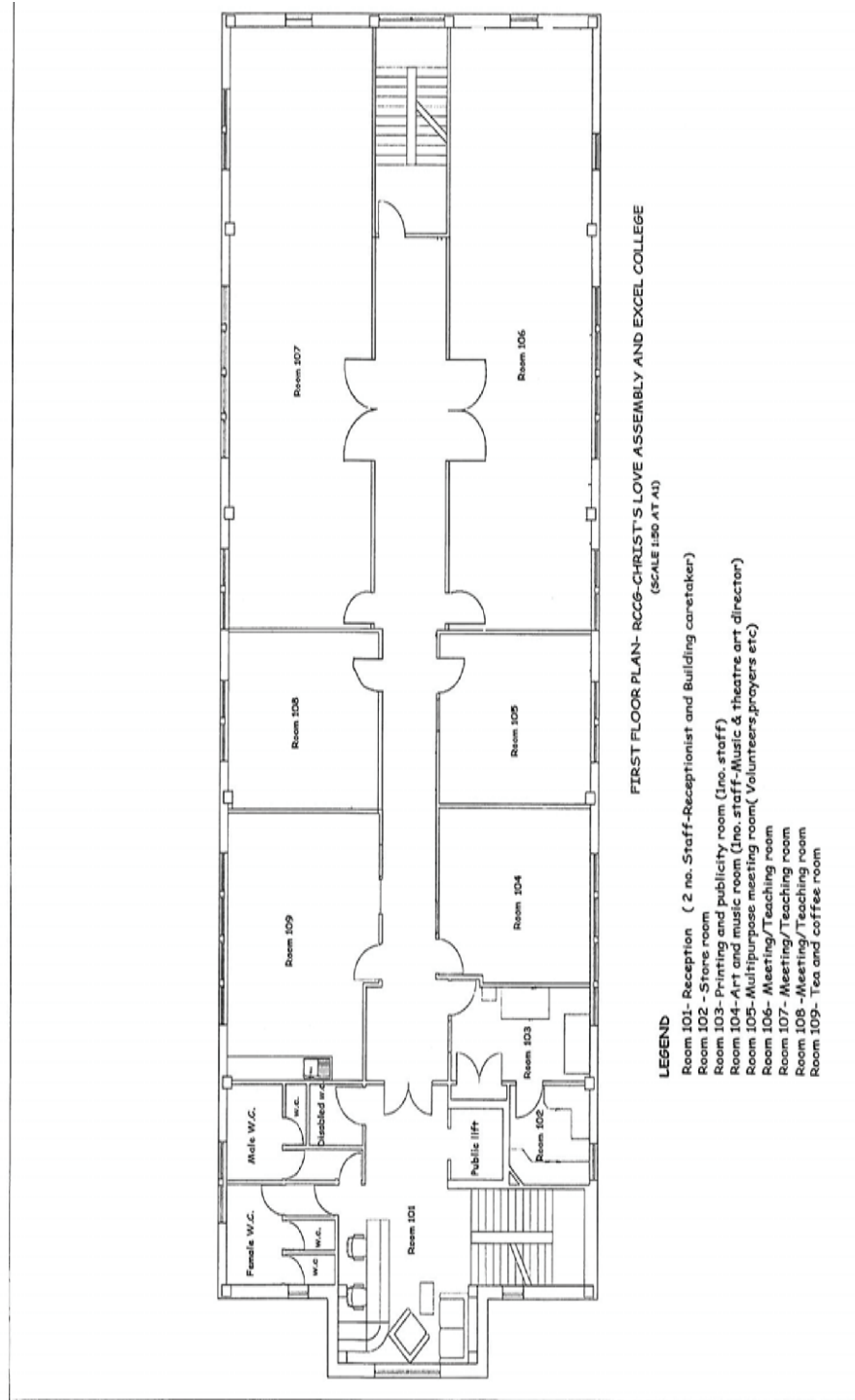

# Second floor plan

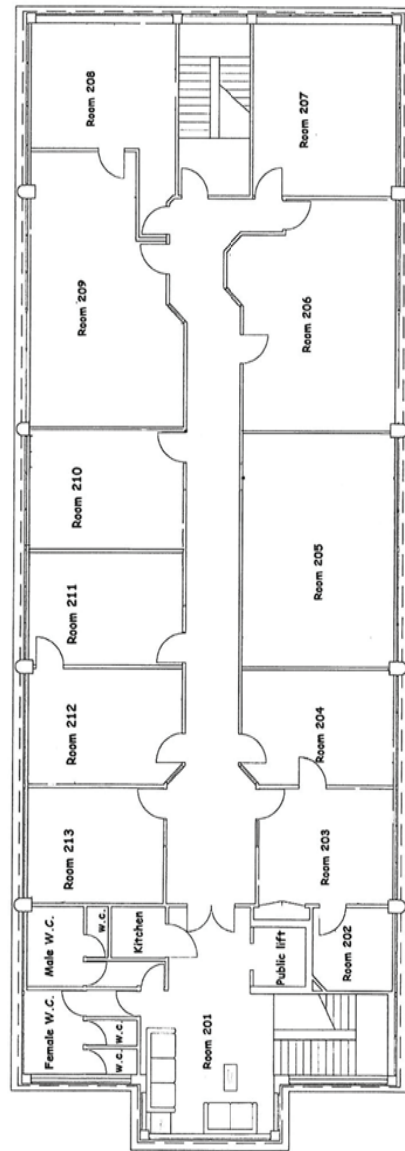

SECOND FLOOR PLAN-EXCEL COLLEGE AND RCCS-CHRIST'S LOVE ASSEMBLY OFFICES  
(SCALE 1:50 AT A1)

**LEGEND**

- Room 201- Lobby
- Room 202- Store
- Room 203- Church administration and finance (2no. staff-Administrator and finance officer)
- Room 204- Pastoral care (1no. staff)
- Room 205- Church staff room 1 (2no. full time, 2no. part-time and 2no. volunteers)
- Room 206- Church staff room 2 (2no. full time, 2no. part-time and 2no. volunteers)
- Room 207- Church staff room 3 (1no. full time, 1no. part-time and 2no. volunteers)
- Room 208- College staff room 1 (4no. staff)
- Room 209- Library and IT/Computer room (1no. staff)
- Room 210- College staff room 2 (4no. staff)
- Room 211-Head and Deputy Head office (2no. staff)
- Room 212-Personal Assistants (2no. staff)
- Room 213-College administration and finance (2no. staff)

- Room 205-207 Church staff- Coordinators
- 1. Youth 2. Children 3. Uniting 4. Welfare-Health and Safety 5. Membership management 6. Outreach
- 7. Fellowship 8. Women's Fellowship 9. Prayer
- 10. Generator electricity